

MARCH 2023 ISSUE

eq JOURNAL

NEWS FROM ENERGIEQUELLE

**SUCCESSFUL
COMMISSIONING OPERATIONS**
IN FRANCE & FINLAND

ROBERT HABECK
DELIVERS
FUNDING DECISION

INTERVIEW
WITH TORSTEN ALTMANN,
LBBW LEIPZIG

Image: Konttisuo wind farm

Contents

SUCCESSFUL COMMISSIONING OPERATIONS
IN FRANCE & FINLAND 4

PROJECT DEVELOPMENTS IN GERMANY
VARIOUS WIND FARMS UNDER CONSTRUCTION 6

ROBERT HABECK
DELIVERS FUNDING DECISION 8

ENERGIEQUELLE AS AN EMPLOYER
VARIOUS ADDITIONAL BENEFITS 9

INTERVIEW
WITH TORSTEN ALTMANN, LBBW LEIPZIG 10

FIRST CHARGING STATION PROJECTS
FOR RESIDENTIAL & COMMERCIAL AREAS 12

TRADE FAIRS & EVENTS &
APPEARANCE ON PRO 7 13

15 AND 20 YEARS AT ENERGIEQUELLE
OUR EMPLOYEE ANNIVERSARIES &
A LOOK BEHIND THE SCENES 14



*Dear readers,
dear friends of Energiequelle,*

It has now been five years since we started this biannual magazine with all the news concerning our company. I am very proud of our little anniversary and pleased to present the 10th issue of our eq-JOURNAL!

I am proud of our developements in our European markets: Our third wind farm has now been commissioned in Finland and in France, Trév  /Loud  ac has been successfully feeding into the grid since January. We are also building again in Germany.

In February we had a visit at the reference power plant in Lusatia (RefLau) from Robert Habeck, Federal Minister for Economic Affairs, and Climate Protection. He presented our partners and us with the official funding notice for our reference power plant. The hydrogen storage plant offers a concrete perspective for the transformation of the lignite-based energy region of Lusatia, which is intended to serve as a reference for similar projects in other regions.

In this issue we spoke with Torsten Altmann from LBBW, with whom we have been working successfully for many years. And in our “Behind the scenes” section, we introduce our colleague Jan who despite becoming a dad of four last year, still finds time to take part in the ultramarathon and various other running competitions.

We hope you enjoy our 10th issue!

Michael Raschemann
Managing Director and Owner of Energiequelle



Our
10th issue

YOU CAN NOW ALSO FOLLOW US ON SOCIAL MEDIA





Second Finnish wind farm officially inaugurated in Konttisuo

Konttisuo is the second wind farm we have built with our Finnish subsidiary. It is located at the border between South Ostrobothnia and Central Finland and comprises seven Nordex turbines with a total output of 29.96 MW. Around 22,000 households will be supplied with sustainably produced electricity each year.



We celebrated the inauguration of the park in October last year. As this is the first wind farm in the municipality of Soini, its completion was also a major event and of great interest for the locals. Despite the rainy weather, a total of 500 visitors (out of 2,000 inhabitants in the community) came to the event. Following an information and lobbying event in the morning for the municipality's decision-makers, the two main events of the day were the opening ceremony at the wind farm site and the party in the evening with one of Finland's most popular musicians: Anssi Kela.

Third wind farm in Finland is connected to the grid

Takanebacken wind farm, located in northwestern Finland, successfully fed the first kilowatt hours into the grid at the end of last year.

The construction of the wind farm proceeded according to plan. A total of five Nordex N163 wind turbines with an output of 5.7 MW each were installed. The wind farm therefore produces energy for around 18,000 households. The entire project is carried out under market conditions and without government support.

Takanebacken is the third project that we have connected to the grid since entering the Finnish market in 2015. Our next wind farm is expected to be completed this year in the city of Kalajoki. In total, we are planning wind projects in Finland with a total capacity of around 2,500 MW. The first solar projects are also in the pipeline.

28.5 MW
Supply
of 18,000
households



FRENCH WIND FARM IN TRÉVÉ/LOUDÉAC COMMISSIONED

The six wind turbines contribute a total output of 18 MW to the energy transition in France.

Earlier this year, we commissioned "Le Ménéac wind farm" in the municipalities of Trévé and Loudéac with our French subsidiary, P&T Technologie. The wind farm is located in northwestern France, on the Côtes d'Armor in Brittany. The six new Nordex N-117 wind turbines now complement three existing wind farms developed and built by P&T Technologie in the area. Le Ménéac increases the local installed capacity to 51 MW, which covers the electricity requirements of around 36,000 households per year.

Christoph Biger, site manager at P&T Technologie, is proud of the project's implementation. "Working with local service providers, we were able to build the wind farm on schedule. After Bourbriac, it is now the second wind farm that we have commissioned in France within a few months."

These six turbines increase our total installed capacity in France to 242 MW. Saint-Morand wind farm, totalling 9.4 MW, is also scheduled for commissioning in 2023.



PIERRE DUCHALAIS
International Project Manager



Despite various changes in the law, which repeatedly presented us with new challenges during the planning phase, we were able to bring the project to a successful conclusion thanks to the close and trusting cooperation with P&T and all our partners.

Project developments in Germany

Due to the political situation and the long approval procedures, many projects in Germany have suffered in recent years. We are therefore extremely pleased about the construction of the Großrössen, Bad Gandersheim, Belle-Billerbeck and Heinsdorf wind farms, as well as the approval for the Krummensee wind farm. Overall, we are planning to connect wind and solar farms with a total output of 93 MW to the grid this year, as well as 231 MVA of substation output.



Construction Grossrössen wind farm

Federal state: Brandenburg
Plants: 1x Enercon E-115 EP3 E3
Hub height: 149 m
Rated output: 4.2 MW
Commissioning: Expected spring 2023
Special features of the project: Construction began six years after receiving immission control approval (BImSchG) due to legal action by the local authority. Since the approved windturbine type was no longer available at the time, an amendment was made in accordance with Section 15 BImSchG (immission Control Act) and the construction time regulation was adjusted to speed up the implementation of the project.



Construction Belle wind farm

Federal state: North Rhine-Westphalia
Plants: 6x Enercon E-147
Hub height: 155 m
Rated output: 6x 5 MW
Commissioning: Spring 2023
Special features of the project: A climbing crane was used during construction. We also developed our own app, EQ Smart Stop, to protect large birds and birds of prey. With the help of this app, the targeted shutdown of wind turbines can be controlled during and after mowing and ploughing operations.



Construction Bad Gandersheim wind farm

Federal state: Lower Saxony
Plants: 1x E-160
Hub height: 166 m
Rated output: 5.56 MW
Commissioning: Summer 2023
Special features of the project: For the purpose of repowering, we are replacing four old turbines with one new one, thereby increasing efficiency by over 530 percent.

Construction Heinsdorf wind farm

Federal state: Brandenburg
Plants: 1x Vestas V-150 4.2
Hub height: 125 m
Rated output: 4.2 MW
Commissioning: Expected March 2024
Special features of the project: Cooperation project

Receipt of approval Krummensee wind farm

Federal state: Brandenburg
Plants: 1x Enercon E-138 EP3 E2
Hub height: 160 m
Rated output: 4.2 MW
Commissioning: Expected Spring 2024
Special features of the project: The landowner will participate economically in the project.



Foto: © Angela Regenbrecht

ROBERT HABECK DELIVERS FUNDING DECISION

At the end of February, Robert Habeck, Federal Minister for Economic Affairs and Climate Protection, presented us with the funding decision for the reference power plant Lausitz GmbH (RefLau) at the "Schwarze Pumpe" Industrial Park for a grant of approx. 28.5 million euros.

The Lusatia Reference Power Plant (RefLau) project, in which we have a significant stake along with the "Zweckverband Industriepark Schwarze Pumpe" and Enertrag SE, won the nationwide ideas competition "Reallabore der Energiewende" (Living Labs for the Energy Transition) organised by the Federal Ministry of Economic Affairs several years ago. With its concept for a hydrogen storage power plant, it offers a concrete perspective for the transformation of the lignite-based energy context of Lusatia. On an initial capacity basis of ca. 10 MW, the prototype plant RefLau faces the technical, regulatory and market challenges of building and operating a CO₂-free power plant destined to provide green hydrogen on a demand basis, green hydrogen, green electricity and all system services. The strategic objective is to map the future energy supply on the basis of renewable energy sources and hydrogen, including storage at the "Schwarze Pumpe" industrial park. As a precautionary measure, potential for hydrogen consumption in the region is to be identified. By the time the plant goes into operation in 2025, the first customers will be supplied and synergies will be harnessed in order to establish a local hydrogen economy. The project is intended to serve as a reference for the conversion of conventional power plant sites to renewable energy generation.

At the end of February, Robert Habeck visited us at Dock 3 in Spreetal, thus pledging support for the project. Mr. Habeck commented: "With the Lusatia reference power plant, the BMWK is supporting an important real laboratory that marks a milestone in the transformation from a lignite mining region to an energy transition region. Together with the states of Brandenburg and Saxony, we are today taking a step into the future here in Lusatia, an important step towards climate neutrality. And it will also strengthen the competitiveness of the transnational business location. The Reallabor is a project from the region for the region. I would like to thank all those involved who believed in the project and are now making it a reality."

The Fraunhofer IEG, the BTU Cottbus/Senftenberg and the Dresden University of Technology are our partners in research.

Energiequelle as an employer Flexible, personal and appreciative

We have high goals: to double the number of employees in the next five years and enter the market in two more countries. Working to ensure the entire team's satisfaction is our most important form of leverage to this end. For this, we are constantly developing as a company and offer our colleagues various additional benefits.

This year, for example, the holiday entitlement was raised to 30 days for everyone. Christmas and New Year's Eve are now also free days. Employees who have been with us for a particularly long time also get additional annual leave: Being with us for 10 years of company affiliation of means 32 days' leave, after 15 years this becomes 34 days through to 36 days after 20 years. So it pays to stay.

Since last year, employees have been able to take advantage of the Wellpass, a subsidized sports pass offer, and use the annual health budget we provide for this purpose. Those who would like to improve their English have the opportunity to take part in lessons with our partner Babel. And those who are new to the company are invited to our newly introduced Welcome Day. At our main location in Kallinchen, there will be lots of information and introductory sessions on this day, small get-to-know-you games as well as a joint dinner. The next day we also go to Feldheim, our energy self-sufficient village: A big highlight for all newcomers!

What is most important to us in all of this is to maintain the family atmosphere and to always uphold our core values: humanity, personal exchange, open doors and appreciation for each other.

We are delighted that some of our colleagues' children are already gaining their first professional experience in our company and that the Energiequelle family is constantly growing.

In order to convey precisely this sense of togetherness to the outside world, we have designed our own Energiequelle collection just in time for our 25th anniversary. With a hoodie, shirt, cap, bag and socks, our employees can now present themselves as a team in Energiequelle style and carry the message: **Proud part of Energiequelle!**



INTERVIEW

TORSTEN ALTMANN, LBBW LEIPZIG

WHEN AND HOW DID YOU COME IN CONTACT WITH ENERGIEQUELLE?

The relationship has been established for around 13 years. At the time, I was working in Project Finance at LBBW and that's how the first collaboration came about.

WHAT IS YOUR FUNCTION AT LBBW AND WHAT SPECIFIC DUTIES DO YOU FULFIL FOR ENERGIEQUELLE?

I am a corporate client advisor and responsible for the energy and infrastructure business areas at LBBW in Leipzig. This makes me the first point of contact for Energiequelle in our company for all financing issues. This includes corporate financing — with services such as working capital loans, guarantees, interest rate hedging, payment transactions and leasing as well as company pension schemes — and all national and international project financing.

WHO DO YOU DEAL WITH AT ENERGIEQUELLE?

First and foremost, I talk to Maik Pytzka. We have been working together very constructively and pleasantly for many years. I value him for his extensive competence and experience and have found him to be a very pleasant interlocutor. In addition, I regularly interact with Kirsten Donker and Jörg Karaschewski in a good, professionally competent and pleasant atmosphere.

HOW WOULD YOU DESCRIBE THE COOPERATION WITH COLLEAGUES AT ENERGIEQUELLE?

Fair partnership of equals immediately comes to mind. Both sides understand each other's challenges and work constructively. We try to achieve goals together. In practice, this means that we can reach each other directly and, if necessary, at short notice and rely on mutually agreed schedules and the quality of information.

WHAT MAKES WORKING WITH LBBW SPECIAL? WHAT VALUES CHARACTERISE YOUR RELATIONSHIPS WITH CLIENTS AND PARTNERS?

We are a regionally rooted and internationally networked financial institution. As an institution under public law, LBBW has a corporate and social mandate. For us, these are two sides of the same coin. We want to help shape a sustainable future with values from our 200-year history and innovative ideas - for the benefit of our clients, owners, employees and society. One of the goals is to promote sustainable growth. Sustainability and social commitment are therefore firmly anchored in our business objectives.

WHY IS THERE SUCH A GOOD FIT BETWEEN LBBW AND ENERGIEQUELLE?

LBBW has been active in the field of renewable energies since the mid-1990s, and for us sustainability has already been one of the key growth areas for years. We know the industry very well and understand Energiequelle's business model. Of course, this helps enormously with financing. We are also active internationally in the same markets, for example in France and Finland. So there are many similarities and opportunities for cooperation. In short, we speak the same language.

WHAT MAKES ENERGIEQUELLE STAND OUT IN YOUR EXPERIENCE?

The compatibility of work and family life is very important to the company, as you can see. Fair cooperation is also a strength of Energiequelle and is reflected in part in the long service record of its employees. With my contacts, I always sense that team spirit, employee development and open communication are values that are practised in the company. I really appreciate that - not least because of many overlaps with our own values.

WHERE DO YOU SEE THE BIGGEST CHALLENGES IN THE ENERGY INDUSTRY AT THE MOMENT?

The aim is to reduce dependence on fossil fuels, broaden our supplier base and stabilise supply chains. In addition, sufficient capital strength in the market is essential to implement the planned growth of renewable energies. The timely expansion of renewable energies and the reduction of CO₂ emissions are high on the agenda. However, we must not forget one factor: The energy transition will only be a success if we gain the acceptance and support of the population.

WHAT DO YOU VALUE ABOUT WORKING WITH ENERGIEQUELLE?

Open and fair cooperation. If I have a concern, I can be sure that it will be taken seriously. All contact persons at Energiequelle try to find constructive solutions. This applies to my direct contacts all the way to the managing partner and entrepreneur Michael Raschemann, who, with his innovative ideas and concepts as well as his expertise, has built up the company excellently and established it sustainably on the market.

WHAT HAVE YOU ALWAYS WANTED TO TELL ENERGIEQUELLE?

Thank you very much for the good and trusting cooperation. We know what this true partnership means and look forward to the projects to come.

Torsten Altmann

Senior Corporate Client Advisor Energy and Infrastructure LBBW, Leipzig



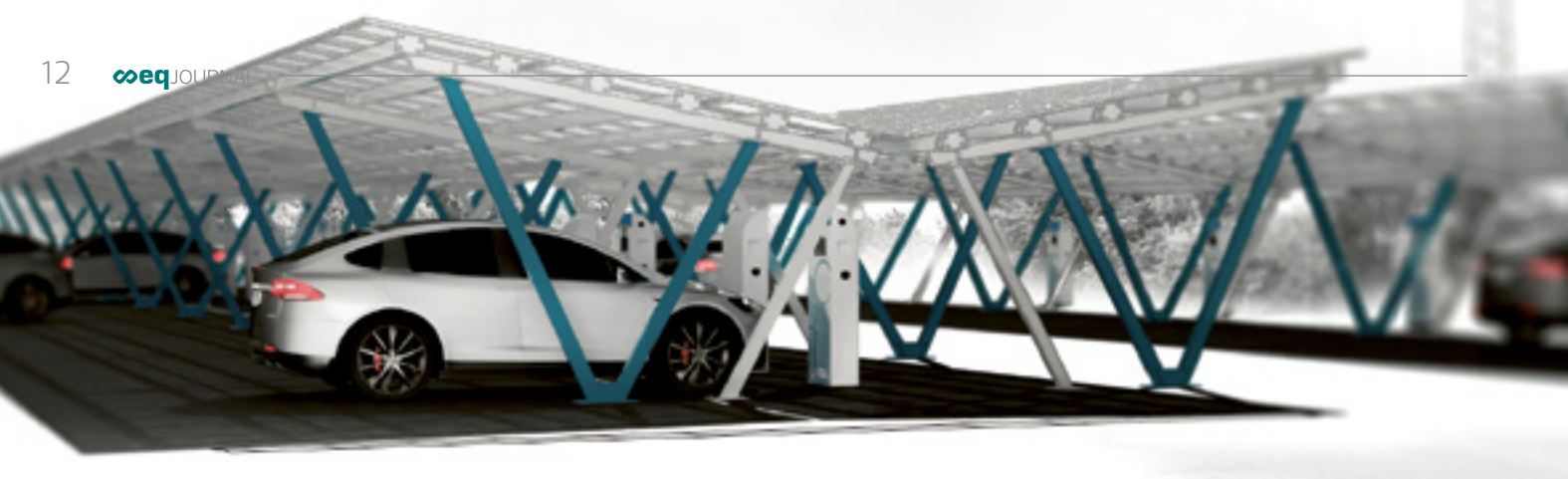

First charging station projects for residential and commercial areas

Energiequelle's business development department is currently developing five major charging infrastructure projects for electric vehicles in residential and commercial properties.

In 2021, the Building Electromobility Infrastructure Act (GEIG) created a legal framework for the construction of integrated charging and power infrastructure specifically for residential areas. Among other things, this stipulates that newly built and renovated residential and non-residential buildings with a certain number of parking spaces must be pre-equipped for charging stations or even equipped with charging stations.

The major challenge here is the grid connection capacity and the billing of the charging current for the respective users. To meet this requirement, we project intelligent and highly available system solutions that relieve the load on the grid connection with dynamic load management and also enable usage-based authorisation and billing via RFID recognition. In conjunction with decentralised energy generation systems, combined with electricity storage solutions, we reduce the amount of electricity drawn from the grid and provide users with clean, economical and locally generated charging power.

With our entry into the project planning and operational management of charging infrastructure projects, we are consistently pursuing our own corporate course. Today, more than two-thirds of our colleagues already drive fully or at least partially electric company vehicles. At our site in Kallinchen, we operate a large charging station with 43 charging points. In addition to providing charging power for employees, the charging station serves as a kind of field laboratory for the ongoing testing of innovative and demand-oriented system solutions. In order to meet the increasing demand and new product challenges, our project team and partner network are continuously being expanded.

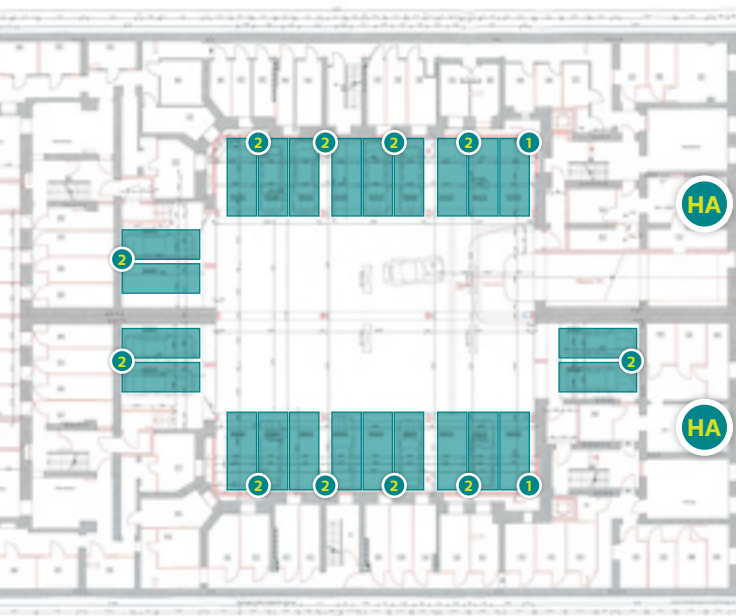

Trade fairs & appearances

2022 was a busy year for trade fairs and events. In addition to various industry days at which we were represented, WindEnergy in Hamburg was a long-awaited event. The world's leading trade fair for the wind energy sector was finally able to take place again in its old form and brought players closer together again after the absence due to the pandemic. At our paperless stand, which was dedicated to our 25th anniversary, we awaited our guests with a model of our reference power plant in Lusatia, let the visitors compete at our "Hot Wire Game", attracted large crowds with soft ice cream and partied with our partners at our large stand. We celebrated our anniversary and the successful trade fair until midnight with snacks, drinks and music.

We were also at the MeLa, the Mecklenburg Agricultural Exhibition, the Tarmstedt Exhibition and the Energy Decentral (part of EuroTier, Europe's largest agricultural fair). Here, visitors were able to climb a wind turbine with virtual reality goggles and find out at the stand whether their surfaces are suitable for wind energy or photovoltaics. We had many interesting conversations and are already looking forward to the next fairs!

In October, we were able to admire our Managing Director Michael Raschemann on television. He was a guest on the Pro 7 politics show on climate change and energy prices. He talked about Feldheim, the energy self-sufficient village we built together with partners in Brandenburg and which does not feel the effects of rising energy costs due to its independence and its own electricity grid. Michael Raschemann then talked to Claudia Kemfert, Katrin Goering-Eckardt, Kevin Kühnert and presenter Linda Zervakis. A big evening for him and us alike!



CONGRATULATIONS 20 YEARS AT ENERGIEQUELLE



Manuel Zimmermann celebrated his 20th anniversary on 1 October 2022. He started with us as an employee in operations management, later moving on to become a wind farm manager and then a regional manager. In 2019, he took over the North-East region and built up further operations management sites in recent years. Thank you very much for your commitment, your loyalty and your consistently reliable work! We wish you all the best and are very happy to have you in the Energiequelle team.



Nicole Lafin has been in the Energiequelle team since 7 October 2002. After her training as an office administrator, she started with us in technical operations management and soon, graciously agreed to become the department's "fairy godmother" as well. At the beginning of 2011, she switched to customer support and since then, with her kind manner, has ensured satisfied customers in and around plants' operation. Thank you very much for your commitment and your reliable exemplary work! We wish you all the best and are delighted that you are here.



Uta Müller has been an assistant at Energiequelle since 1 November 2002. For almost 20 years, Uta has supported the entire "Project Family" at the main site in Kallinchen with great passion and heart. She has now been the good soul of the business development team since 2022. Uta does handicrafts, decorates, is creative and well organised. Uta therefore provides energetic and reliable support at every event. Dear Uta, we thank you very much for your constant commitment and look forward to many more years with you!

15 YEARS AT ENERGIEQUELLE



DANIEL WIECZOREK
Asset Management Specialist
1 October 2007



MARCO GEISS
Operational Management Team Leader
1 October 2007



CHRISTIANE HOLSTEIN
Senior Payroll Specialist
1 October 2007



JAN SCHROBDSORFF
Project Manager

A look behind the scenes

We hold our colleague Jan in Bremen in high regard. Although he became a father of four last year, he regularly runs in extreme races. For example, he jogs 80 kilometres through the Harz mountains once a year in the ultramarathon and organises the Bremen KSB run, where you have to run 6.7 kilometres in one hour and keep running until you no longer can. Jan managed an incredible 12 laps = 80.4 kilometres. As a project developer, this much perseverance is of course an advantage. So keep it up!

“

ENERGIEQUELLE

Tomorrow's
Energy.

IMPRINT

Editor: Energiequelle GmbH, Hauptstraße 44,
15806 Zossen, T +49 3376 98 71 0

Responsible for content:
Susanne Tauke with the editorial team

Design: Energiequelle: Judith Bürger

Print: BerlinDruck GmbH + Co KG

Copyright: All texts and images are protected by copyright.
The copyright is held by Energiequelle GmbH.

Images: Energiequelle GmbH, SchmidtKord, Angela Regenbrecht

Print run: 2,200 copies



RECYCLED
Papier aus
Recyclingmaterial
FSC® C011814



Energiequelle GmbH

Head office in Kallinchen near Berlin

Hauptstraße 44
15806 Zossen OT Kallinchen
T +49 33769 871 0

Bremen

Heriwardstraße 15
28759 Bremen
T +49 421 626 769 0

and many other locations

www.energiequelle.de/en
info@energiequelle.de

